

Crankshaft Position Sensor Replacement

Removal Procedure

Warning: Refer to [Safety Glasses Warning](#) in the Preface section.

Danger: To avoid any vehicle damage, serious personal injury or death when major components are removed from the vehicle and the vehicle is supported by a hoist, support the vehicle with jack stands at the opposite end from which the components are being removed and strap the vehicle to the hoist.

1. Turn the ignition OFF.

Raise and support the vehicle. Refer to [Lifting and Jacking the Vehicle](#).

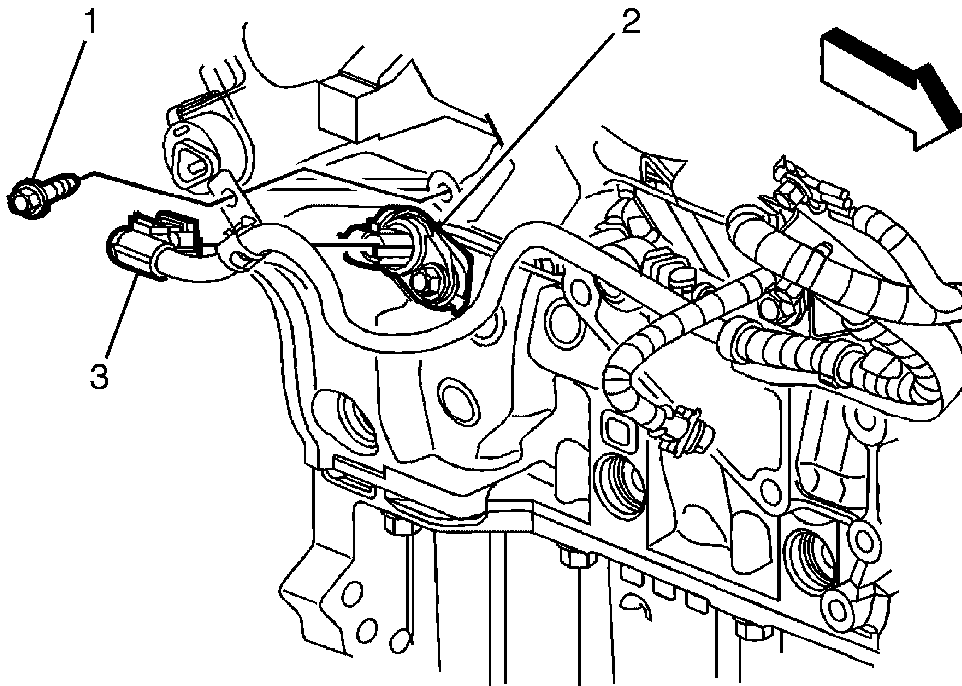

2. Reposition the wiring harness heat shield to obtain access.

3. Disconnect the crankshaft position (CKP) harness connector (3) from the CKP.

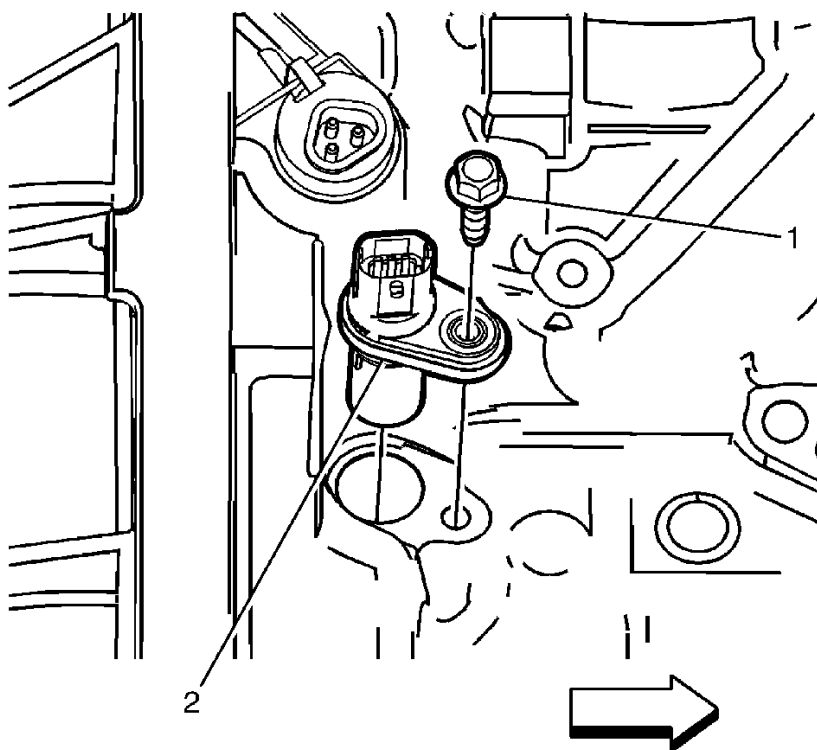

4. Remove the CKP to engine block retaining bolt (1) from the CKP sensor (2).
5. Remove the CKP sensor (2) from the engine block.

Installation Procedure

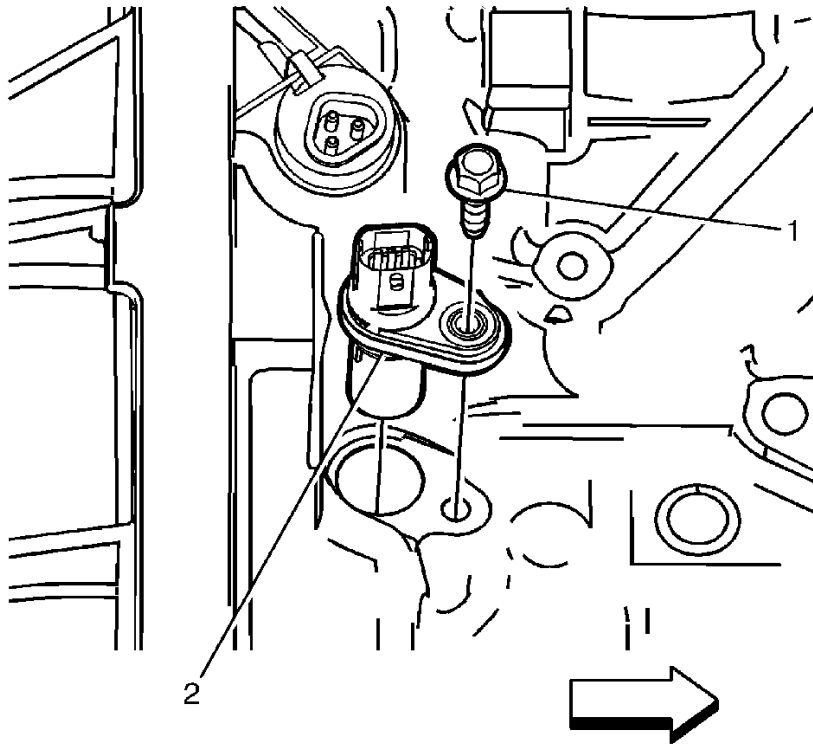

1. Install the CKP sensor (2) to the engine block.

Caution: Refer to **Fastener Caution** in the Preface section.

2. Install the CKP sensor to engine block retaining bolt (1) and tighten to **10 N·m (89 lb in)**.

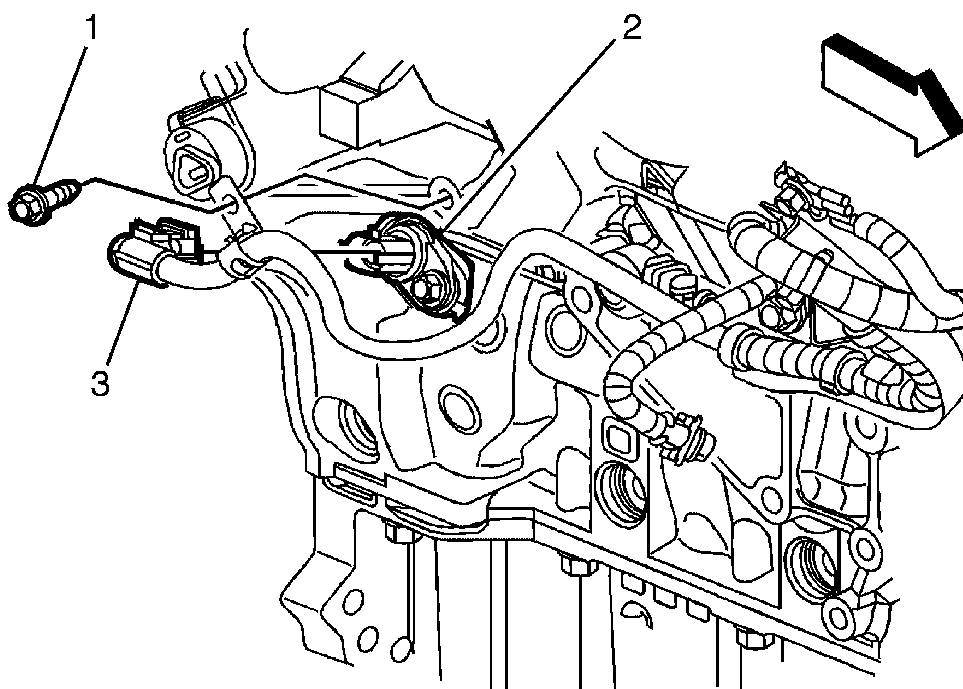

3. Connect the CKP electrical connector (3) to the CKP sensor.
4. Lower the vehicle.