

Rewiring the VT Exec, Berlina, and Calais to accommodate Monaro Headlights.

When fitting the Monaro headlights onto VT series cars, the low beam lights will not function properly and can be classed as Unroadworthy. This problem can be seen when the high beams are activated, due to the style of lamp (pencil beam) there is no light shown on the edges of the road. The Monaro overcomes this by turning on the Low beam lamps when the High beam lamps are activated.

To correct this, changes need to be made to the “Flash Dip Switch” wiring on the steering column, (turn signal Switch connector 2).

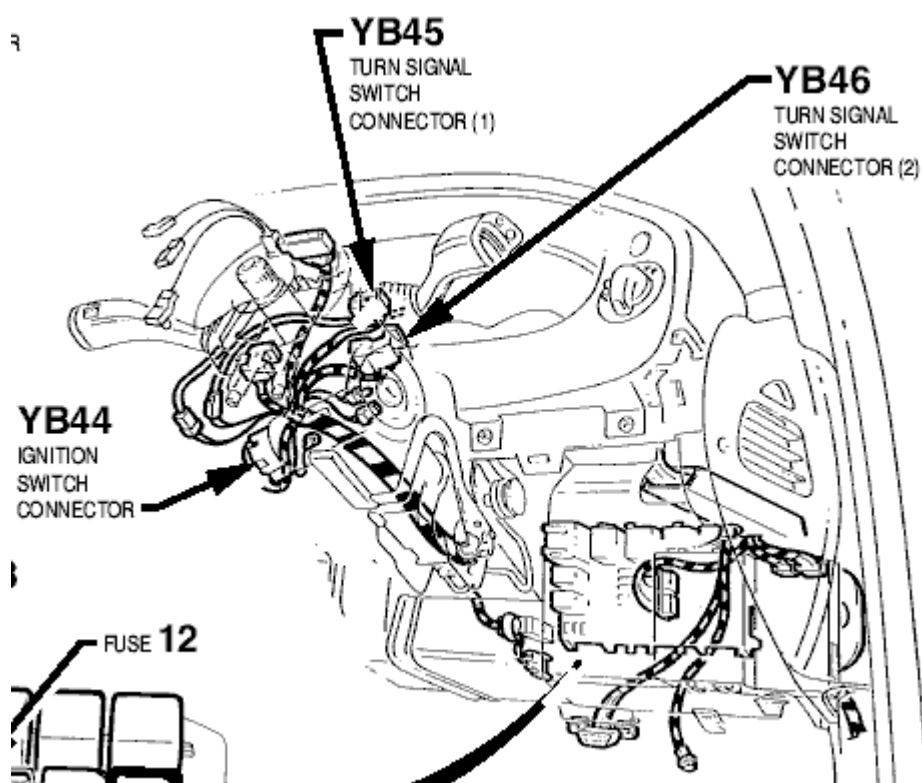

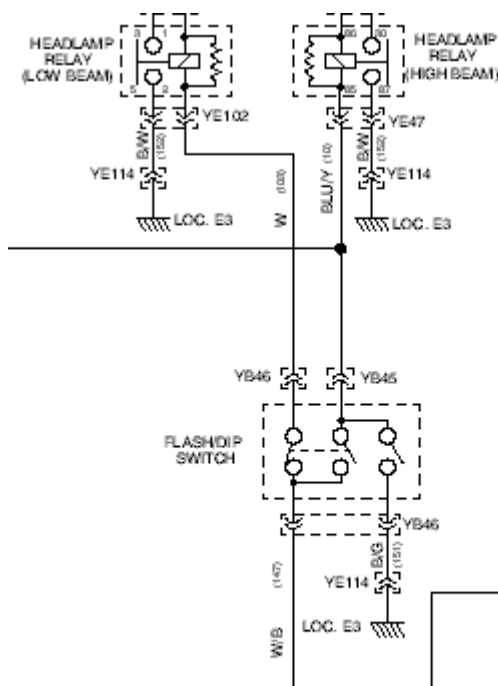
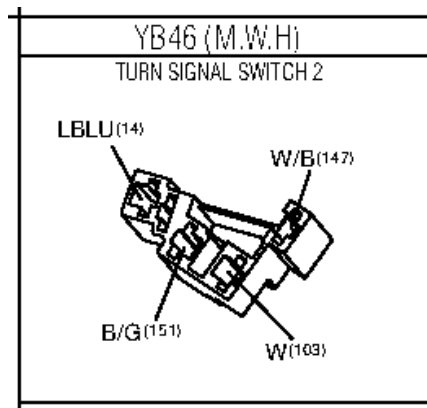

Standard Executive, Flash Dip Switch

As can be seen above the standard Dip switch has four wires on the YB46 plug

- Pin 1 BLU/Y
- Pin 2 W
- Pin 3 W/B
- Pin 4 B/G

On the Monaro Plug, Pin 2, White is removed and joined to the Pin 3 wire, white/black.

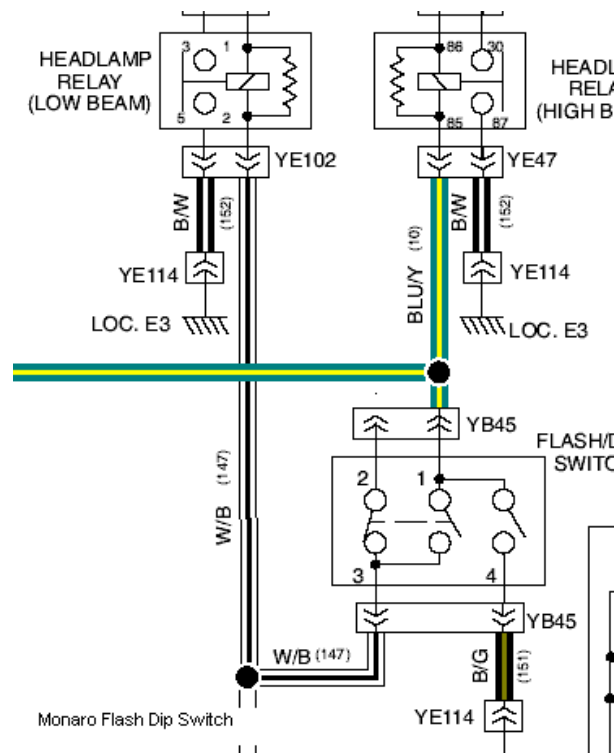

To make this modification remove the Steering column covers as shown below. Unplug and remove the two plugs from the Indicator stalk and remove the stalk.

Locate the White wire on pin 2 of the YB46 plug and cut it next to the plug. This wire then needs to be joined to the white/black wire on pin 3. Ensure that this join is secure (i.e.solder or crimp connector) and cannot come loose with vibrations.

Reconnect the plugs and reinstall the stalk and steering column panels.

7. Insert finger between the steering wheel and the lower cover as shown and apply a small amount of force, pushing the cover toward the instrument cluster.
8. Remove the upper cover by lifting upwards, then rearwards.

