

2.9 REAR DOOR EXTERIOR HANDLE ASSEMBLY

RE MOVE

1. Remove the door inner trim panel refer [2.5 FRONT AND REAR DOOR INNER TRIM PANEL](#) in this Section.
2. Remove the two screws securing the inner trim panel retaining bracket to the door and remove retaining bracket. Remove inner trim retaining brackets by levering out the centre pin of bracket.
3. Carefully peel off the water deflector from the door inner panel.

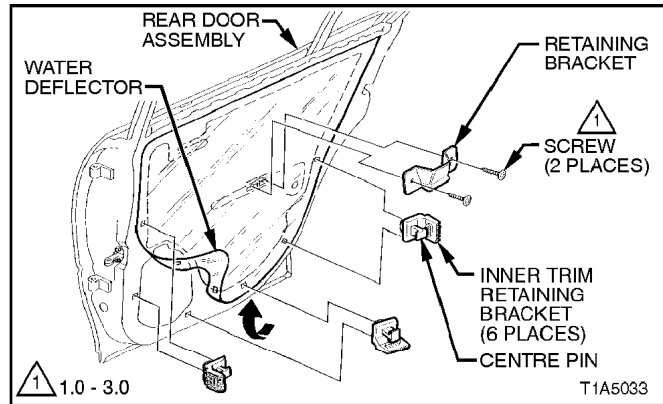

Figure 1A5-19

4. Remove the two exterior door handle retaining nuts, and remove exterior door handle.

REINSTALL

Reinstallation of the rear door exterior handle assembly is the reverse of the removal operation, noting the following:

1. Ensure that the adjuster nut is seated in the lock assembly before installing the exterior door handle assembly retaining nuts.
2. Tighten retaining nuts to the correct torque specification.

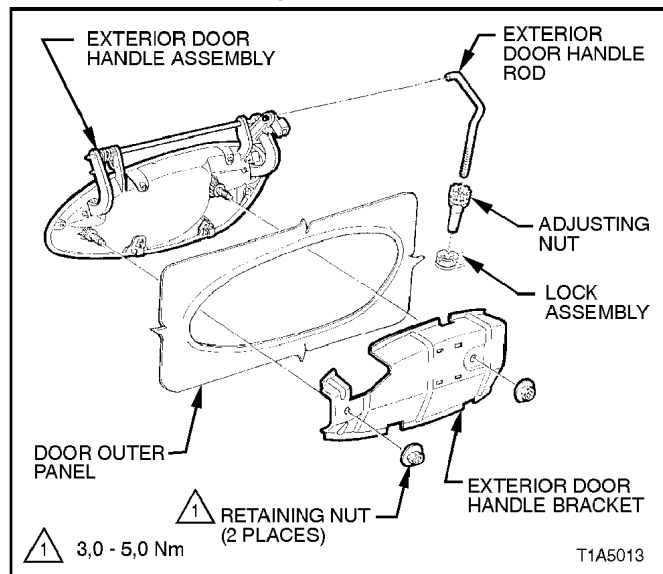

Figure 1A5-20

EXTERIOR DOOR HANDLE
RETAINING NUT
TORQUE SPECIFICATION

3 - 5 Nm

3. Check and if necessary, adjust the exterior door handle adjustment nut to allow latch disengagement with striker when the exterior door handle opening is $18^\circ \pm 5^\circ$ from the rest position.
4. Ensure the water deflector is sealed correctly to the door panel.
5. Use a new door locking button retaining clamp.