

Steering Column Lock Control Module Replacement

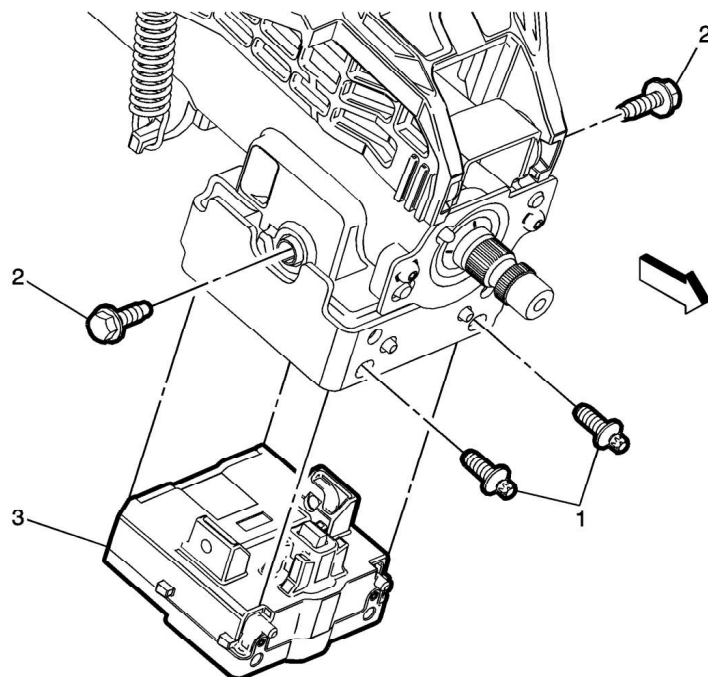

Steering Column Lock Control Module Replacement

Callout	Component Name
Preliminary Procedures	
<ol style="list-style-type: none">1. Ensure the steering wheel and the front wheels are in the straight ahead position.2. Remove the right side instrument panel lower trim panel insulator. Refer to Instrument Panel Lower Trim Panel Insulator Replacement - Right Side.3. Remove the right side floor front air outlet duct. Refer to Floor Front Air Outlet Duct Replacement - Right Side.4. With foot off the brake pedal and the shift lever in the PARK position, press the ignition and start switch once. This will place the ignition system in the ACCESSORY (ACC) mode and unlock the steering column for 5 minutes.5. Turn the steering wheel to verify the steering column is not locked.6. Disconnect the steering column lock control module electrical connectors.7. With foot off the brake pedal and the shift lever in the PARK position, press the ignition and start switch once. This will place the ignition system in the OFF mode and leave the steering column unlocked as long as the electrical connectors are disconnected.8. Remove the steering column. Refer to Steering Column Replacement.	
1	<p>Steering Column Lock Control Module Bolt (Qty: 2)</p> <p>Caution: Refer to Fastener Caution.</p> <p>Procedure</p> <ol style="list-style-type: none">1. Remove the old steering column lock control module bolts. Discard the bolts.

Callout	Component Name
	<p>2. When installing the new steering column lock control module, install the NEW steering column lock control module bolts and tighten until the bolt heads break off.</p> <p>Note: Start all fasteners by hand before breaking the bolt heads off or misalignment of the steering column lock control module may occur.</p>
2	<p>Steering Column Lock Control Module Bolt (Qty: 2)</p> <p>Tighten</p> <p>9 N•m (80 lb in)</p>
3	<p>Steering Column Lock Control Module</p> <p>Procedure</p> <p>After installation is complete, program and set up the steering column lock control module. Refer to Control Module References.</p>

Instrument Panel Lower Trim Panel Insulator Replacement - Right Side

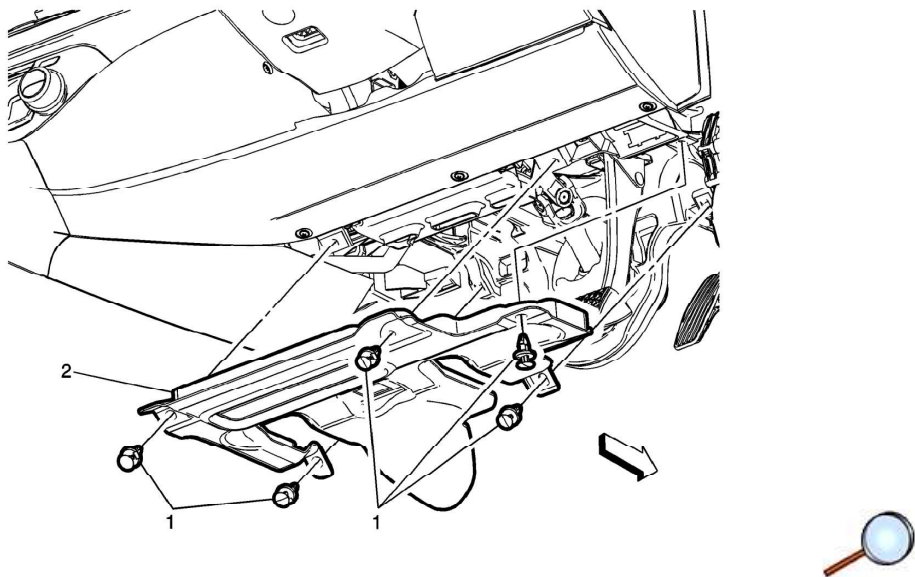

Instrument Panel Lower Trim Panel Insulator Replacement - Right Side

Callout	Component Name
1	Instrument Panel Insulator Retainer (Qty: 5) Procedure Use a suitable tool to release the retainers securing the lower trim panel insulator to the instrument panel assembly. <small>© 2014 General Motors. All rights reserved.</small>
	Instrument Panel Lower Trim Panel Insulator - Right Side

2

Procedure

1. Disconnect the electrical connection.
2. Transfer components as necessary.

Floor Front Air Outlet Duct Replacement - Right Side

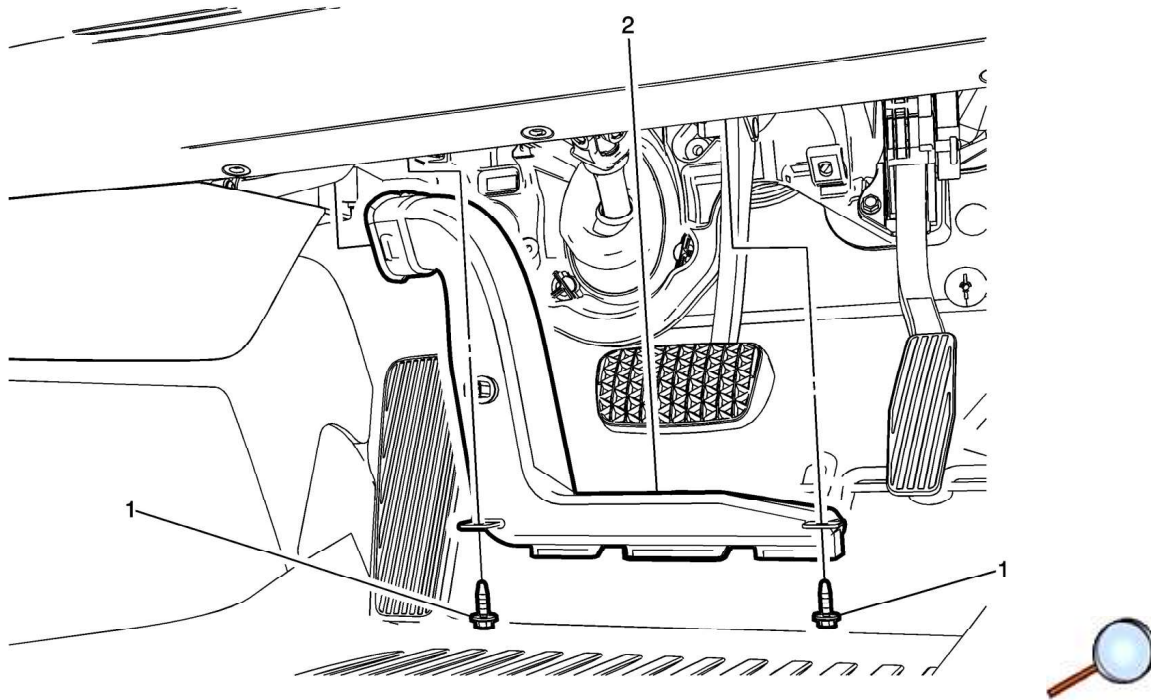

Floor Front Air Outlet Duct Replacement - Right Side

Callout	Component Name
Preliminary Procedure Remove the right side instrument panel lower trim panel insulator. Refer to Instrument Panel Lower Trim Panel Insulator Replacement - Right Side .	
1	Floor Front Air Outlet Duct Fastener (Qty: 2) Caution : Refer to Fastener Caution . Tighten 2.0N•m (18 lb in)
2	Floor Front Air Outlet Duct — Right Side Procedures 1. Disconnect the right lower duct air temperature sensor electrical connector. 2. Transfer the components as necessary.