

3.3 GEARSHIFT LEVER KNOB AND BOOT ASSEMBLY

NOTE:

The gearshift lever knob and console boot are manufactured as a single component. Do not attempt to remove the gearshift lever knob separately to the boot.

REMOVE

1. With the fingers of one hand hooked under the edge of the gearshift lever boot as shown, carefully release each of the 8 plastic retainers and free the gearshift lever boot from the console cap.

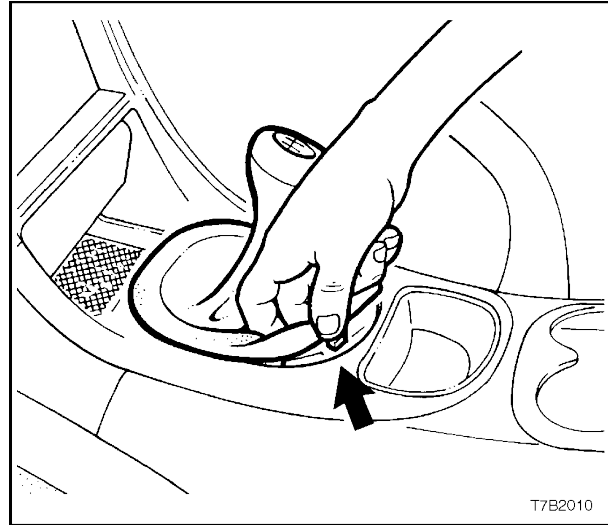

Figure 7B1-12

2. Lift the gearshift lever boot enough to enable a firm grasp to be made on the gearshift lever with the left hand, then grasp the gearshift knob with the right.
3. While rocking the knob sideways, and with an upward force applied, dislodge the knob retaining claws from the lever.
4. Remove the gearshift lever knob and boot assembly, from the gearshift lever.

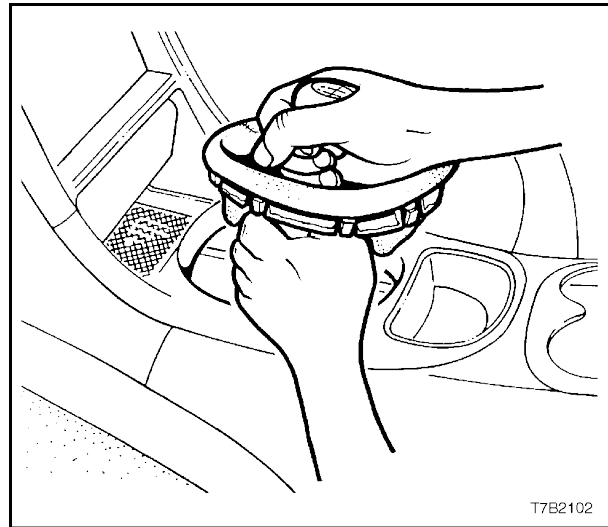

Figure 7B12-13

REINSTALL

1. Reinstall the knob and boot assembly over the gearshift lever, align the knob in the correct attitude and then bump the knob onto the gearshift lever until the retaining claws engage with the groove in the lever.
2. Align the boot retaining clips with the hole in the console cap, then carefully seat the boot retainers into the console cap until each clip engages correctly.