

## 4.4 Front Door Window Guide Channel Assembly

### Remove

- 1 Lower the front door window to the down position.
- 2 Remove the following components as required:
  - a Trim panel assembly, refer to [3.1 Front Door Trim Panel](#).
  - b Speaker, refer to [Section 12D Entertainment System](#).
  - c Window belt outer reveal moulding assembly, refer to [5.3 Front Door Window Belt Outer Reveal Moulding Assembly](#) or [6.3 Front Door Window Belt Outer Reveal Moulding Assembly](#).
- 3 Remove the trim panel bracket (1), three places, from the inner panel (2) by levering out the centre pin of each bracket.
- 4 Carefully peel off the water shield (3) from the inner panel.

#### NOTE

The water shield only need to be partly removed to allow access to complete this procedure.

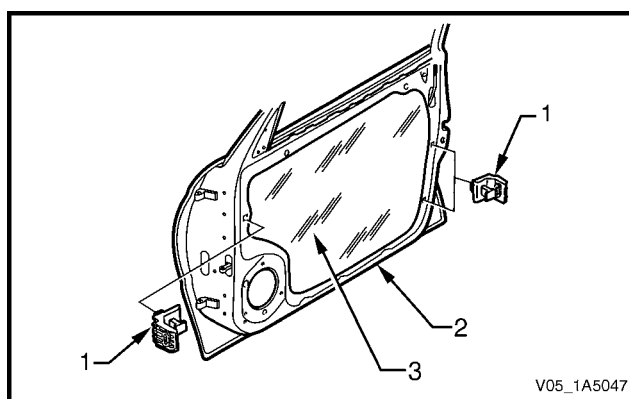

Figure 1A5 - 45

- 5 Remove the two inner panel beltline seals (1) from the front door assembly.

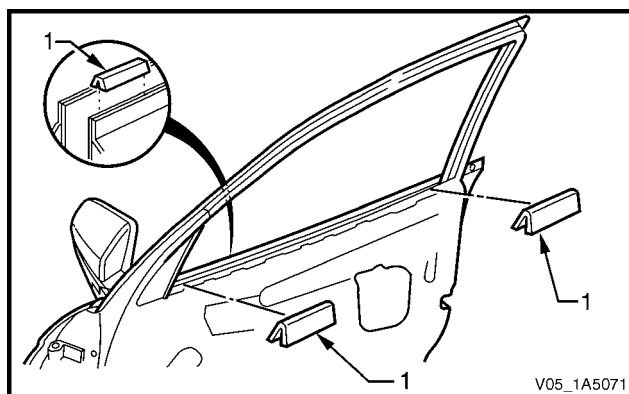

Figure 1A5 - 46

- 6 Carefully remove the window upper weatherstrip assembly (1) from the window guide channel assembly (2).

#### NOTE

It is not necessary to remove the upper weatherstrip assembly completely; remove it only from the window guide channel assembly.

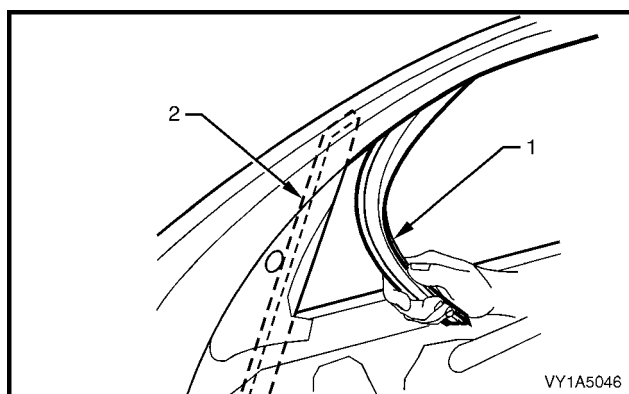

Figure 1A5 - 47

- 7 Remove the exterior rear-view mirror, refer to [Section 12H Rear-view Mirrors](#).
- 8 Partially remove the upper weatherstrip assembly (1) from the lip on the door upper frame, to access the window guide channel cap (2).

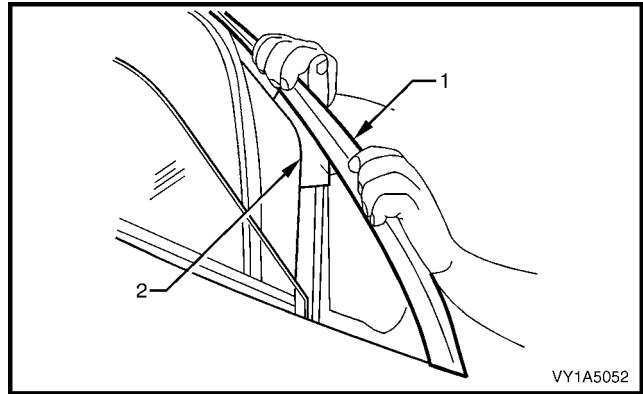

Figure 1A5 - 48

- 9 Carefully peel back the window guide channel self-adhesive cap (1) away from the window guide channel (2).

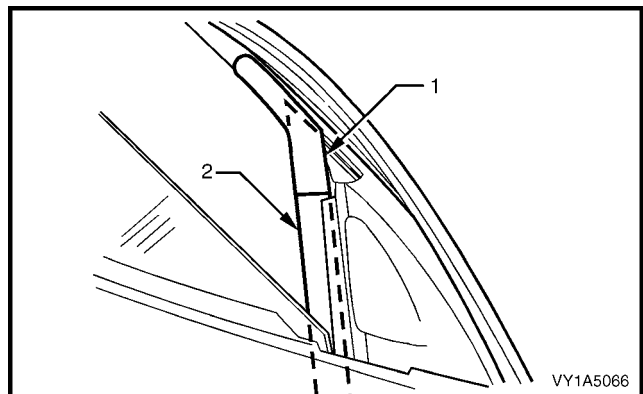

Figure 1A5 - 49

- 10 Remove the window down stop screw (1) from the window guide channel assembly (2).

**NOTE**

Do not remove the window down stop nut (3) as it is encapsulated in the guide channel.

- 11 Remove the upper and lower screws (4) attaching the window guide channel assembly to the inner panel (5).

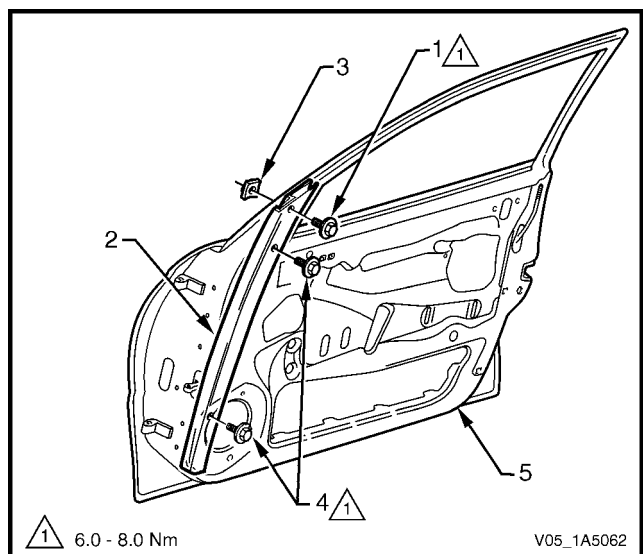

Figure 1A5 - 50

- 12 Remove the window guide channel assembly (1) from the door assembly (2) in an upward direction, disengaging the window assembly slides (3) from the window guide channel assembly.

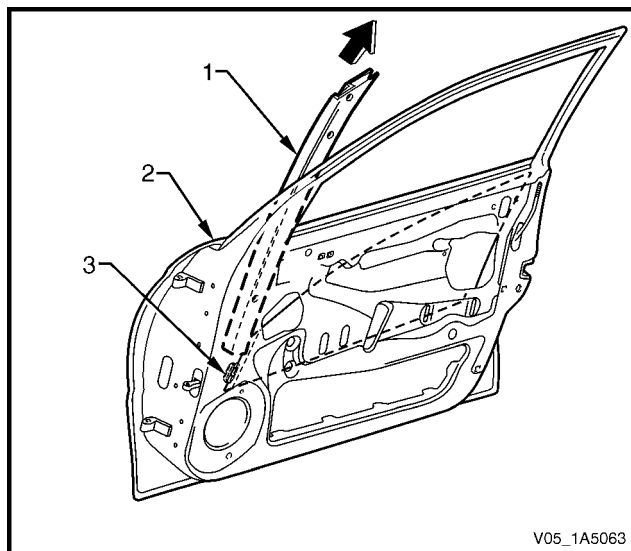

Figure 1A5 – 51

## Reinstall

Reinstallation of the front door window guide channel assembly is the reverse of the removal procedure, noting the following:

- 1 Ensure the window assembly slides are engaged in the window guide channel assembly.
- 2 Tighten the upper and lower screws (4) attaching the window guide channel assembly (3) to the correct torque specification, refer to Figure 1A5 – 50.

Front door window guide channel assembly upper attaching screw torque specification .....	6.0 – 8.0 Nm
---	--------------

Front door window guide channel assembly lower attaching screw torque specification .....	6.0 – 8.0 Nm
---	--------------

- 3 Tighten the window down stop screw (1) to the correct torque specification.

Front door window down stop screw torque specification .....	6.0 – 8.0 Nm
--	--------------

- 4 Align the self-adhesive cap (1) flush with the upper edge of the door frame (2) and the front edge of the window guide channel (3).
- 5 Wrap the overhang of the self-adhesive cap into the door frame and the window guide channel.
- 6 Ensure the upper weatherstrip assembly (4) is correctly fitted onto the lip of the door upper frame.

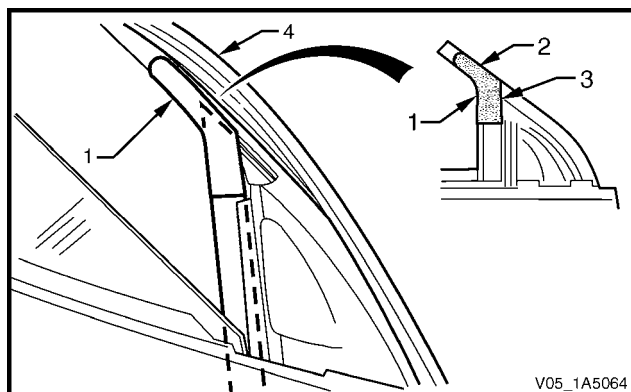

Figure 1A5 – 52

- 7 Ensure the window upper weatherstrip assembly (1) is pushed back fully into the window guide channel assembly (2), refer to Figure 1A5 – 47.

## 4.5 Front Door Window Regulator Assembly

### Remove

- 1 Remove the Trim panel assembly, refer to 3.1 Front Door Trim Panel.
- 2 Remove the trim panel bracket (1), three places, from the inner panel (2) by levering out the centre pin of each bracket.
- 3 Carefully peel off the water shield (3) from the inner panel.

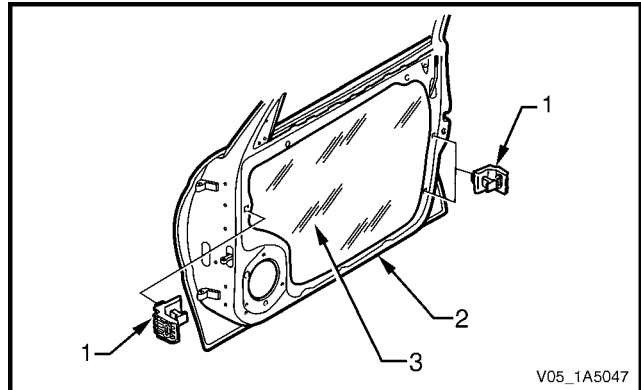

Figure 1A5 – 53

- 4 Lower the window assembly to a position where the window regulator sliders and the two window guide rails (1) are visible through the aperture (2) in the inner panel.

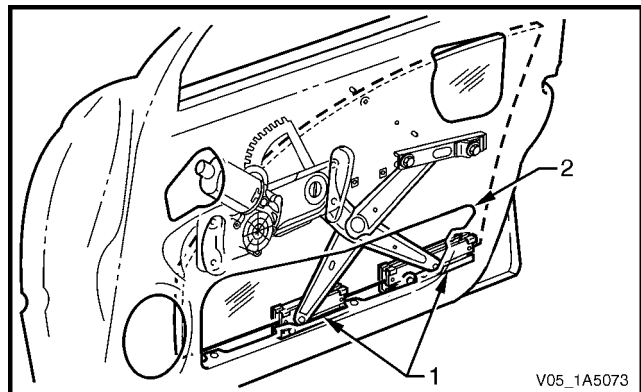

Figure 1A5 – 54

- 5 Remove the two screws (1) attaching the window regulator channel assembly (2) to the inner panel.
- 6 Push the window regulator channel assembly out of the slider (3) on the window regulator counter balance arm (4).
- 7 Remove the window regulator channel assembly through the upper opening (5) in the inner panel.

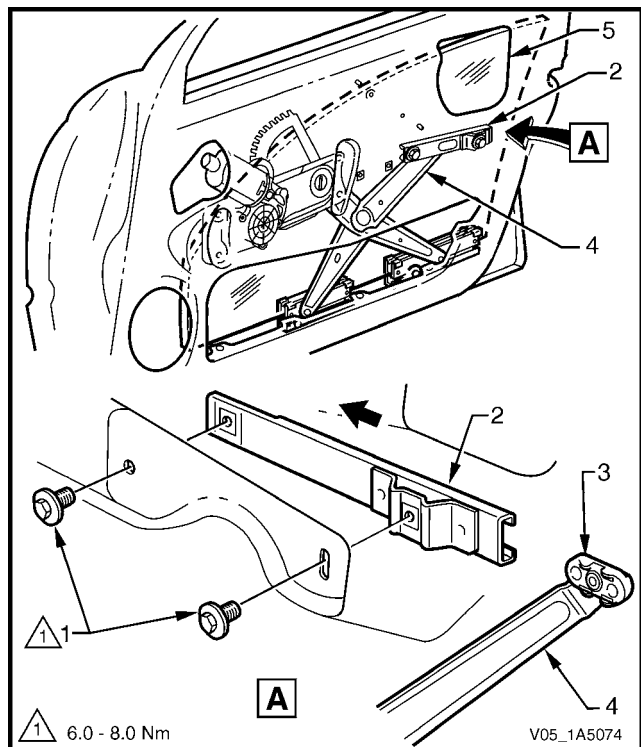

Figure 1A5 – 55

- 8 Disconnect the window regulator assembly wiring harness connector (1).
- 9 Have an assistant to support the window glass and drill out the four rivets (2) securing the window regulator assembly (3) to the inner panel.

#### NOTE

Use a 5 mm drill bit to drill out the four rivets securing the window regulator assembly.

- 10 Move the two window regulator sliders (4) out of the two window guide channels (5).
- 11 Raise the window glass by hand.
- 12 Remove the window regulator assembly through the inner panel aperture (6).
- 13 Place a wooden chock inside the door assembly to hold the window glass pannel up, while replacing the window regulator assembly.

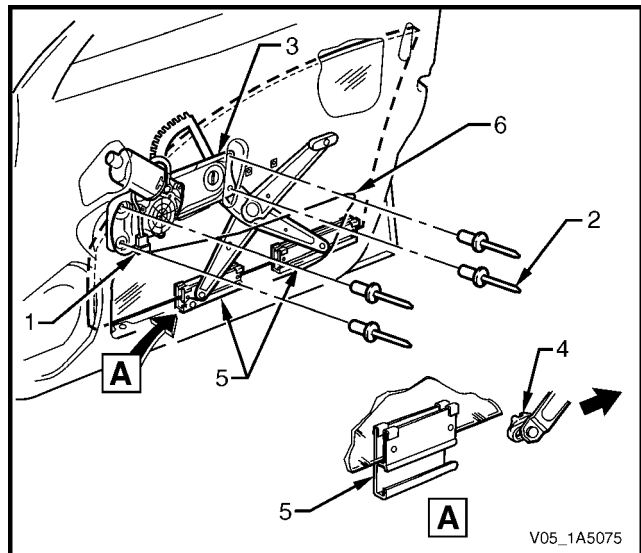

Figure 1A5 – 56

## Reinstall

Reinstallation of the front door window regulator assembly is the reverse of the removal procedure, noting the following:

- 1 Ensure that all frictional surfaces of the window regulator assembly and associated parts are adequately lubricated with Lithium base grease NLGI No. 1 (with 9 % zinc oxide) or equivalent.
- 2 Align the attaching holes in the window regulator assembly with the corresponding holes in the inner panel and secure the window regulator assembly with 5 mm rivets.

#### NOTE

Washers may be inserted when installing the rivets as the attaching holes in the inner panel may have been enlarged when the rivets were drilled out.

- 3 Fit the slider of the counter balance arm in the channel assembly and secure loosely with the two attaching screws, do not torque at this stage.
- 4 Adjust the window and regulator assemblies, then torque the attaching screws as per the adjustment procedure, refer to [4.6 Front Door Window Assembly](#).

## 4.6 Front Door Window Assembly

### Remove

- 1 Remove the following components as required:
  - a Trim panel assembly, refer to [3.1 Front Door Trim Panel](#).
  - b Window regulator assembly, refer to [4.5 Front Door Window Regulator Assembly](#).
  - c Window belt outer reveal moulding assembly, refer to [5.3 Front Door Window Belt Outer Reveal Moulding Assembly](#) or [6.3 Front Door Window Belt Outer Reveal Moulding Assembly](#).
  - d Window guide channel assembly, refer to [4.4 Front Door Window Guide Channel Assembly](#).
- 2 Lift the window assembly (1) up through the door belt opening and slide to the rear.

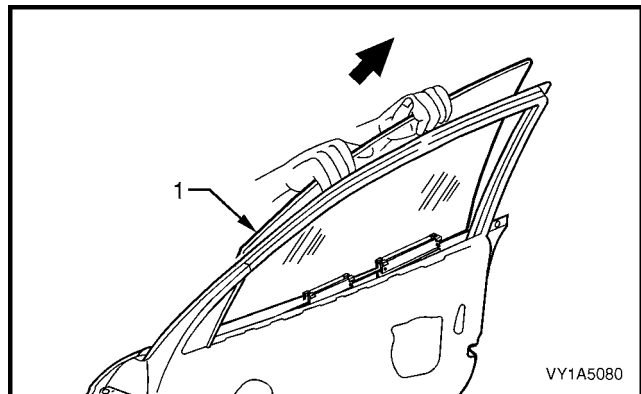

Figure 1A5 – 57

### Reinstall

Reinstallation of the front door window assembly is the reverse of the removal procedure, noting the following:

- 1 Insert the window assembly down through the door belt opening taking care not to damage the glass panel.

#### NOTE

Do not torque any component attaching screw prior to adjusting the window and regulator assemblies.

- 2 When installing the window regulator assembly, make sure to adjust the window and regulator assemblies as per the adjusting procedure as described in this section, refer to Adjust.

## Adjust

Figure 1A5 – 58 shows the screw / nut locations and torque values for the front door window assembly adjustment procedure.

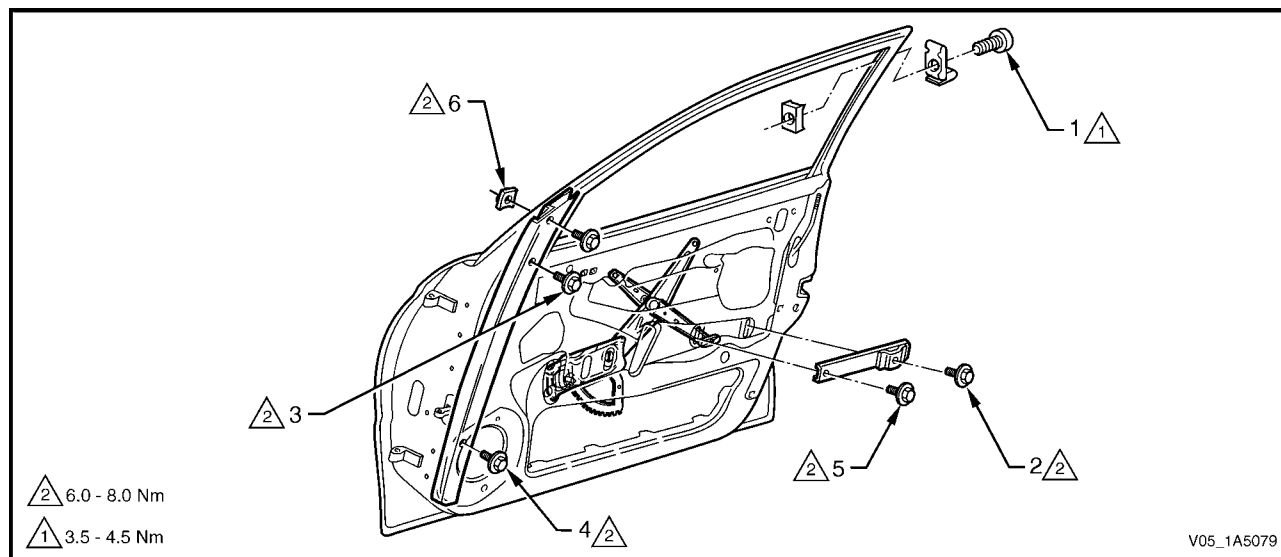

Figure 1A5 – 58

### Legend

- |   |  |   |  |
|---|--|---|--|
| 1 | Front Door Window Up Stop Screw and Nut                        | 4 | Front Door Window Guide Channel Assembly Lower Attaching Screw |
| 2 | Front Door Window Regulator Channel Rear Attaching Screw       | 5 | Front Door Window Regulator Channel Front Attaching Screw      |
| 3 | Front Door Window Guide Channel Assembly Upper Attaching Screw | 6 | Front Door Window Down Stop Screw and Nut                      |

- 1 Adjust the window assembly up stop, point (1) at the rear of the front door so there is a 1 mm gap below the highest possible end stop position.
- 2 Tighten the window up stop screw, point (1), to the specified preliminary torque value.

Front door window up stop screw preliminary torque specification.....2.0 Nm

- 3 Wind the window assembly up through area (Z), until it is approximately 30 mm before the closed position. At the same time press the rail, which is bonded to the rear edge of the window assembly, forward (Y).
- 4 Secure the window regulator channel assembly in position without imposing any stress, by tightening the rear attaching screw, point (2), to the specified torque.

Front door window regulator channel rear attaching screw torque specification .....6.0 – 8.0 Nm

- 5 Tighten the window guide channel assembly upper attaching screw, point (3), to the specified torque. Ensure the window assembly is held approximately 30 mm before the closed position.

Front door window guide channel assembly upper attaching screw torque specification .....6.0 – 8.0 Nm

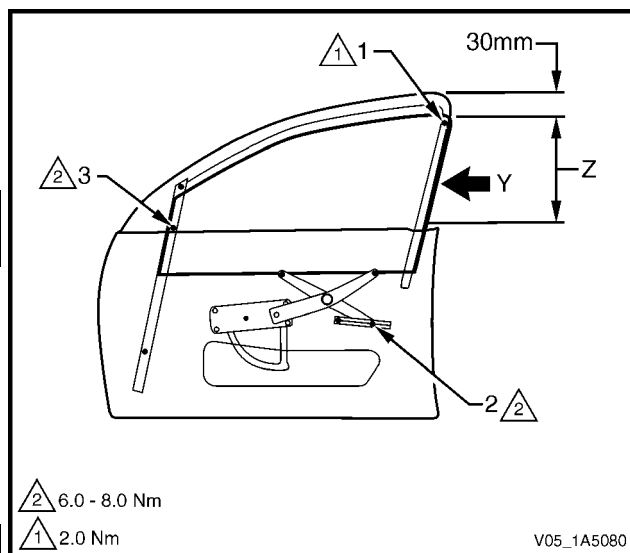

Figure 1A5 – 59

- 6 Wind the window assembly down to approximately 30 mm above the belt outer reveal moulding assembly. At the same time press the rail at the rear edge of the window assembly, forward (Y). Tighten the window guide channel assembly lower attaching screw, point (4), to the specified torque.

Front door window guide channel  
assembly lower attaching screw  
torque specification .....6.0 – 8.0 Nm

- 7 Secure the window regulator channel assembly in position without imposing any stress, by tightening the front attaching screw, point (5), to the specified torque.

Front door window regulator  
channel front attaching screw  
torque specification .....6.0 – 8.0 Nm

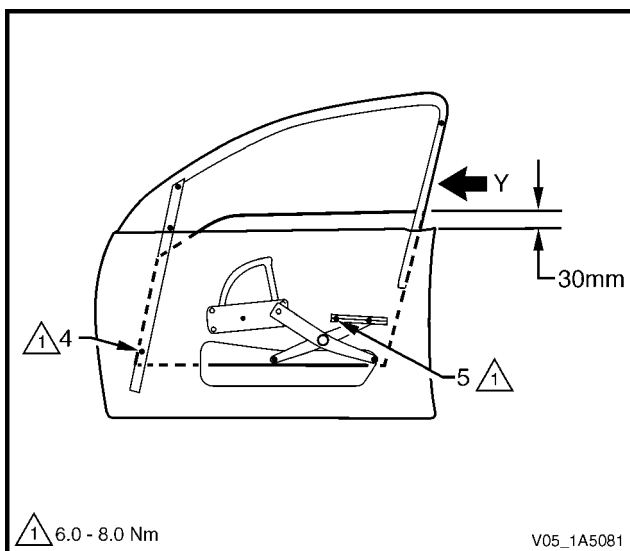

Figure 1A5 – 60

- 8 Wind the window assembly up to a position where its upper edge is flush with the upper edge of the exterior rear-view mirror housing, as seen from the outside. In this position, the upper edge of the window assembly must be parallel with point (X) on the window upper weatherstrip assembly, over area (W).
- 9 Check the cranking load of the window assembly in area (V). If the window assembly binds or the motor load sounds excessive, re-adjust the window assembly by correcting the guide channel attachment points (3 and 4).
- 10 Adjust the window down stop screw, point (6), so the down stop nut contacts with the window. Tighten the window down stop screw to the specified torque.

Front door window down stop screw  
torque specification .....6.0 – 8.0 Nm

- 11 Check the window for the following:
- The upper edge of the window must be parallel to the lip of the door upper frame run channel at point (X) and over the area (W).
  - The upper edge of the window must be inserted by 4 mm  $\pm$  1 mm above the lip of the door upper frame run channel at point (X) and over the area (W).

#### NOTE

If either the deviation in parallelism or the insertion depth exceeds 1 mm from specification, the stop assemblies at points (1 and 6) must be readjusted.

- 12 Tighten the window up stop screw (1), to the specified final torque value.

Front door window up stop screw  
torque specification .....3.5 – 4.5 Nm

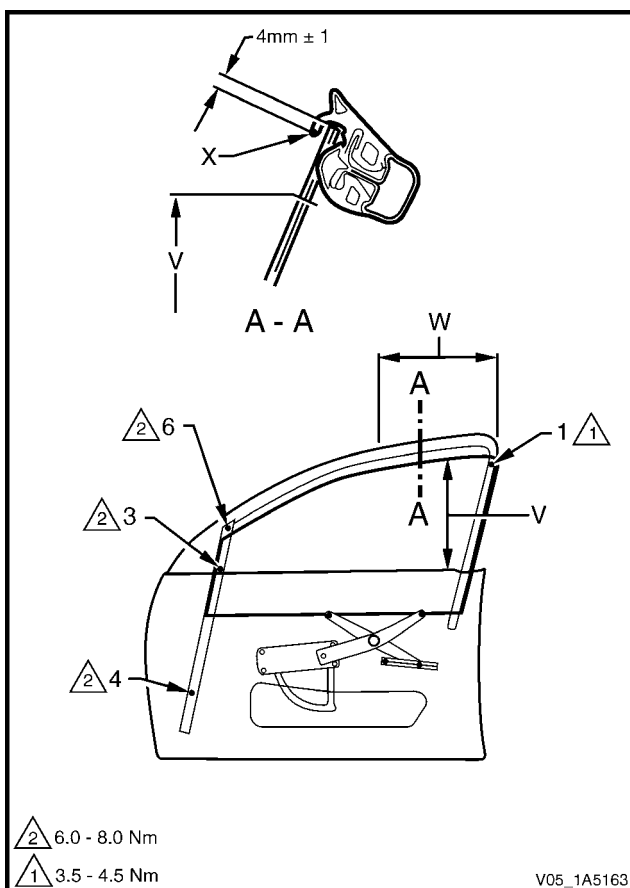

Figure 1A5 – 61